

**PORT OF DOUGLAS COUNTY  
RESOLUTION NO. 2022-01**

**IN THE MATTER AUTHORIZING NEW PORT OF DOUGLAS COUNTY COMMISSIONER  
DISTRICT BOUNDARIES PURSUANT TO NEWLY ADOPTED AND REVISED DOUGLAS  
COUNTY COMMISSIONER DISTRICTS**

**Whereas**, the Douglas County Board of Commissioners adopted Resolution C.E. 21-38B on December 14, 2021 authorizing new legal descriptions and the maps of the voter precincts and commissioner districts in Douglas County, Washington; and,

**Whereas**, the Port of Douglas County is a county-wide port district with the same number of commissioner districts as Douglas County; and,

**Whereas**, the Port of Douglas County, per RCW 53.16 and RCW 29A.76 is required to use the commissioner districts adopted by the Douglas County Board of Commissioners,

**Now, Therefore, Be It Resolved** that the Board of Commissioners for the Port of Douglas County hereby ratifies and approves the legal descriptions of the revised port commissioner districts as attached hereto as Exhibit A, and as adopted by the Douglas County Board of Commissioners, as applicable to the County Commissioner Districts.

**Adopted** by the Commission of the Port of Douglas County, at a regular meeting thereof held this 11<sup>th</sup> day of January, 2022.

**PORT OF DOUGLAS COUNTY**

  
\_\_\_\_\_  
Jim Huffman, President

  
\_\_\_\_\_  
W. Alan Loebsock, Vice President

  
\_\_\_\_\_  
Mark Spurgeon, Secretary

PORT OF DOUGLAS COUNTY  
COMMISSIONER DISTRICT 1  
April 27, 2012 (Unchanged)

Commencing in Section 11, Township 22 North, Range 20 East, W.M. at the intersection of the southwesterly extension of the centerline of 9<sup>th</sup>. St. NE. and the Boundary of Douglas County, being also the main channel of the Columbia River, said point being the TRUE POINT OF BEGINNING FOR THIS DESCRIPTION; thence northerly along said Boundary of Douglas County and said main channel of the Columbia River to an intersection with a westerly extension of the east-west center-section line of Section 25, Township 24 North, Range 20 East, W.M.; thence easterly along the east-west center-section line line of said Section 25 and it's westerly extension to the east quarter corner of said Section 25, said point being also the northwest corner of Section 30, Township 24 North, Range 21 East, W.M.; thence continuing easterly along the north line of said Section 30, to the northeast corner thereof; thence southerly along the east line of said Section 30 and the east line of Section 31, Township 24 North, Range 21 East, W.M. to the southeast corner of said Section 31, said point being also the southwest corner of Section 32, Township 24 North, Range 21 East, W.M.; thence easterly along the southerly line of said Section 32 to the southeast corner of said Section 32, being also the northeast corner of Section 5, Township 23 North, Range 21 East, W.M.; thence southerly along the east line of said Section 5 and the east line of Sections 8, 17, 20 and 29, Township 23 North, Range 21 East, W.M. to the east quarter corner of said Section 29; thence westerly along the east-west center-section line of said Section 29 and also the east-west center-section line of Section 30, Township 23 North, Range 21 East, W.M. and Section 25, Township 23 North, Range 20 East, W.M. to the west quarter corner of said Section 25, said point being also on the east line of Section 26, Township 23 North, Range 20 East, W.M.; thence northerly along the east line of said Section 26 to the northeast corner of said Section 26; thence westerly along the north line of said Section 26 to an intersection with the east right of way of SR-28; thence southerly along said east right of way, as said line would continue through points of intersecting street right of way lines, to an intersection with the east-west center-section line of said Section 26; thence easterly along said east-west center-section line to the center of said Section 26; thence southerly along the north-south center-section line of said Section 26 to an intersection with the center of Canyon B; thence northeasterly along said center of Canyon B to an intersection with the centerline of Eastmont Avenue; thence southerly along said centerline of Eastmont Avenue to the centerline of 23<sup>rd</sup>. St. NE.; thence westerly along the said centerline of 23<sup>rd</sup>. St. NE. to the centerline of SR-28; thence southerly along said centerline of SR-28 to an intersection with a westerly extension of the north right of way of 19<sup>th</sup>. St. NE.; thence easterly along said north right of way, as said line would continue through points of intersecting street right of way lines, and it's westerly extension to the west right of way of N. Baker Avenue; thence northerly along said west right of way of N. Baker Avenue, as said line would continue through points of intersecting street right of way lines, to a point that is west of the northwest corner of Canyon Creek Condominiums; thence easterly to said northwest corner of Canyon Creek Condominiums; thence northeasterly along the north line of said Canyon Creek Condominiums to the northeast corner thereof, said point being also on the west right of way of the Greater Wenatchee Irrigation District Canal; thence northeasterly crossing the said Greater Wenatchee Irrigation District Canal to the northwest corner of the Country Club Crescent Condominiums, said point being also on the east right of way of said Greater Wenatchee Irrigation District Canal; thence southeasterly and southerly along the north and east lines of said Country Club Crescent Condominiums to the northwest corner of The Legends Condominiums; thence southeasterly along the north line of said The Legends Condominiums to the northwest corner of the Plat of Tanglewood Townhomes; thence southeasterly along the north line of said Plat of Tanglewood Townhomes to the west line of Lot 4, Block 3 of the plat of East Wenatchee Fruit Farms; thence northerly along said west line of Lot 4, Block 3, East

Wenatchee Fruit Farms to the northwest corner thereof; thence easterly along the north line of said Lot 4, Block 3 to the northwest corner of Lot 3, Orchards Short Subdivision; thence southerly along the west line of said Lot 3, Orchards Short Subdivision to the southwest corner thereof; thence easterly along the south line of said Lot 3, Orchards Short Subdivision and also the south line of Lots 1 and 2, Orchards Short Subdivision to the southeast corner of said Lot 1, said point being also on the west line Lot 32, Earhart Heights Subdivision; thence southerly along said west line to the southwest corner of said Lot 32; thence easterly along the south line of said Lot 32 to the southeast corner of said Lot 32, said point being also on the west right of way of Eastmont Avenue; thence southeasterly on a line between the southeast corner of said Lot 32 and the southwest corner of Parcel 3, Floyd Crane Short Plat to an intersection with the centerline of said Eastmont Avenue; thence southerly along the centerline of said Eastmont Avenue to the west quarter corner of Section 1, Township 22 North, Range 20 East, W.M.; thence easterly along the east-west center-section line of said Section 1 to the center of said Section 1; thence southerly along the north-south center-section line of said Section 1 to a point that is 1004.4 feet north of the south quarter corner of said Section 1; thence turning an angle of 90° and running easterly to the east right of way of N. Jackson Avenue; thence southerly along said east right of way of N. Jackson Avenue to the north right of way of 10<sup>th</sup>. St. NE.; thence easterly along the north right of way of said 10<sup>th</sup>. St. NE. to an intersection with the north line of Section 12, Township 22 North, Range 20 East, W.M.; thence easterly along the north line of said Section 12 to the northeast corner thereof; thence southerly along the east line of said Section 12 to an intersection with the east right of way of N. Kentucky Avenue; thence southerly along the east right of way of said N. Kentucky Avenue, as said line would continue through points of intersecting street right of way lines, to the centerline of 3<sup>rd</sup>. St. NE.; thence westerly along the centerline of said 3<sup>rd</sup>. St. NE. to the centerline of Eastmont Avenue; thence northerly along the centerline of said Eastmont Avenue to an intersection with a northeasterly extension of the centerline of 2<sup>nd</sup>. St. NE.; thence southwesterly along the centerline of said 2<sup>nd</sup>. St. NE. and it's northeasterly extension to the centerline of N. Colorado Avenue; thence northwesterly along the centerline of said N. Colorado Avenue to the centerline of 5<sup>th</sup>. St. NE.; thence southwesterly along the centerline of said 5<sup>th</sup>. St. NE. to the centerline of N. Baker Avenue; thence northwesterly along the centerline of said N. Baker Avenue to the centerline of 9<sup>th</sup>. St. NE.; thence southwesterly along the centerline of said 9<sup>th</sup>. St. NE. and it's southwesterly extension to the TRUE POINT OF BEGINNING.

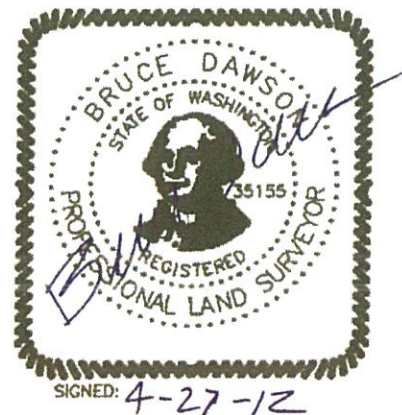



COMMISSIONER DISTRICT 2  
December 9, 2021

Commencing in Section 11, Township 22 North, Range 20 East, W.M. at the intersection of the southwesterly extension of the centerline of 9<sup>th</sup>. St. NE. and the Boundary of Douglas County, being also the main channel of the Columbia River, said point being the TRUE POINT OF BEGINNING FOR THIS DESCRIPTION; thence southerly along said Boundary of Douglas County and said main channel of the Columbia River to an intersection with a southerly extension of the east line of Section 13, Township 20 North, Range 22 East, W.M.; thence northerly continuing along said Boundary of Douglas County leaving said main channel of the Columbia River along said east line of Section 13 and it's southerly extension and also the east line of Sections 12 and 1, Township 20 North, Range 22 East, W.M. to the northeast corner of said Section 1, said point being also on the Fifth Standard Parallel; thence westerly continuing along said Boundary of Douglas County on said Fifth Standard Parallel to the southeast corner of Section 36, Township 21 North, Range 22 East, W.M.; thence northerly continuing along said Boundary of Douglas County leaving said Fifth Standard Parallel on the east line of said Section 36, along with Sections 25, 24 and 13, Township 21 North, Range 22 East, W.M. to the northeast corner of said Section 13, being also the southwest corner of Section 7, Township 21 North, Range 23 East, W.M.; thence easterly continuing along said Boundary of Douglas County on the south line of said Section 7 to the southeast corner thereof; thence northerly continuing along said Boundary of Douglas County on the east line of said Section 7 to the northeast corner thereof, said point being also the southwest corner of Section 5, Township 21 North, Range 23 East, W.M.; thence easterly continuing along said Boundary of Douglas County on the south line of said Section 5 to the southeast corner thereof; thence northerly continuing along said Boundary of Douglas County on the east line of said Section 5 to the northeast corner thereof, said point being also the southwest corner of Section 33, Township 22 North, Range 23 East, W.M.; thence easterly continuing along said Boundary of Douglas County on the south line of said Section 33 to the southeast corner thereof; thence northerly continuing along said Boundary of Douglas County on the east line of said Section 33 to the northeast corner thereof, said point being also the southwest corner of Section 27, Township 22 North, Range 23 East, W.M.; thence easterly continuing along said Boundary of Douglas County on the south line of said Section 27 to the southeast corner thereof; thence northerly continuing along said Boundary of Douglas County on the east line of said Section 27 and also the east line of Section 22, Township 22 North, Range 23 East, W.M. to the northeast corner of said Section 22, said point being also the southwest corner of Section 14, Township 22 North, Range 23 East, W.M.; thence easterly continuing along said Boundary of Douglas County on the south line of said Section 14 to the southeast corner thereof; thence northerly continuing along said Boundary of Douglas County on the east line of said Section 14 to the northeast corner thereof, said point being also the southwest corner of Section 12, Township 22 North, Range 23 East, W.M.; thence easterly continuing along said Boundary of Douglas County on the south line of said Section 12 to the southeast corner thereof; thence northerly continuing along said Boundary of Douglas County on the east line of said Section 12 and also the east line of Section 1, Township 22 North, Range 23 East, W.M. to the northeast corner thereof, said point being also the southwest corner of Section 31, Township 23 North, Range 24 East, W.M.; thence easterly continuing along said Boundary of Douglas County on the south line of said Section 31, and also the south line of Sections 32, 33, 34, 35 and 36, Township 23 North, Range 24 East, W.M., and also the south line of Sections 32, 33, 34, 35 and 36, Township 23 North, Range 25 East, W.M., and also the south line of Sections 31, 32, 33, and 34, Township 23 North, Range 26 East, W.M., to the southeast corner of said Section 34; thence northerly continuing along said Boundary of Douglas County along the east line of said Section 34, and also the east line of Sections 27, 22, 15, 10 and 3, Township 23 North, Range 26 East, W.M. to the northeast corner of said Section 3, said point being also

the southwest corner of Section 35, Township 24 North, Range 26 East, W.M.; thence easterly continuing along said Boundary of Douglas County on the south line of said Section 35 to the southeast corner thereof; thence northerly continuing along said Boundary of Douglas County on the east line of said Section 35 to the northeast corner thereof, said point being also the southwest corner of Section 25, Township 24 North, Range 26 East, W.M.; thence easterly continuing along said Boundary of Douglas County on the south line of said Section 25 to the southeast corner thereof; thence northerly continuing along said Boundary of Douglas County on the east line of said Section 25 to the northeast corner thereof, said point being also the southwest corner of Section 19, Township 24 North, Range 27 East, W.M.; thence easterly continuing along said Boundary of Douglas County on the south line of said Section 19 to the southeast corner thereof; thence northerly continuing along said Boundary of Douglas County on the east line of said Section 19 to the northeast corner thereof, said point being also the southwest corner of Section 17, Township 24 North, Range 27 East, W.M.; thence easterly continuing along said Boundary of Douglas County on the south line of said Section 17 to the southeast corner thereof; thence northerly continuing along said Boundary of Douglas County on the east line of said Section 17 to the northeast corner thereof, said point being also the southwest corner of Section 9, Township 24 North, Range 27 East, W.M.; thence easterly continuing along said Boundary of Douglas County on the south line of said Section 9 to the southeast corner thereof; thence northerly continuing along said Boundary of Douglas County on the east line of said Section 9 to the northeast corner thereof, said point being also the southwest corner of Section 3, Township 24 North, Range 27 East, W.M.; thence easterly continuing along said Boundary of Douglas County on the south line of said Section 3 to the southeast corner thereof; thence northerly continuing along said Boundary of Douglas County on the east line of said Section 3 to the northeast corner thereof, said point being also on the Sixth Standard Parallel; thence easterly continuing along said Boundary of Douglas County on said Sixth Standard Parallel to the southeast corner of Section 31, Township 25 North, Range 28 East, W.M.; thence northerly continuing along said Boundary of Douglas County leaving said Sixth Standard Parallel on the east line of said Section 31 to the centerline of US-2; thence westerly leaving said Boundary of Douglas County along the centerline of said US-2 to an intersection with the west line of Section 6, Township 24 North, Range 26 East, W.M.; thence northerly along the west line of said Section 6 to the northwest corner thereof, said point being also on the Sixth Standard Parallel; thence westerly along said Sixth Standard Parallel to the southeast corner of Section 36, Township 25 North, Range 25 East, W.M.; thence northerly leaving said Sixth Standard Parallel along the east line of said Section 36 and also the east line of Section 25, Township 25 North, Range 25 East, W.M. to the northeast corner of said Section 25; thence westerly along the north line of said Section 25 and also the north line of Section 26, Township 25 North, Range 25 East, W.M. to the northwest corner thereof, said point being also the southeast corner of Section 22, Township 25 North, Range 25 East, W.M.; thence northerly along the east line of said Section 22 to to the northeast corner thereof, said point being also the southwest corner of Section 14, Township 25 North, Range 25 East, W.M.; thence easterly along the south line of said Section 14 to the southeast corner thereof; thence northerly along the east line of said Section 14 and also the east line of Sections 11 and 2, Township 25 North, Range 25 East, W.M. and also the east line of Section 35, Township 26 North, Range 25 East, W.M. to the northeast corner of said Section 35; thence westerly along the north line of said Section 35 and also the north line of Sections 34 and 33, Township 26 North, Range 25 East, W.M. to the northwest corner of said Section 33, said point being also the southeast corner of Section 29, Township 26 North, Range 25 East, W.M.; thence northerly along the east line of said Section 29 and also the east line of Sections 20 and 17, Township 26 North, Range 25 East, W.M. to the northeast corner of said Section 17; thence westerly along the north line of said Section 17 and also Section 18, Township 26 North, Range 25 East, W.M. to the northwest corner of said Section 18, said point being also the southeast corner of Section 12, Township 26 North, Range 24 East, W.M.; thence northerly along the east line of said Section 12 and also the east line of Section 1, Township 26 North, Range 24 East, W.M. to the northeast

corner of said Section 1; thence westerly along the north line of said Section 1 and also the north line of Section 2, Township 26 North, Range 24 East, W.M. to the northwest corner of said Section 2, said point being also the southeast corner of Section 34, Township 27 North, Range 24 East, W.M.; thence northerly along the east line of said Section 34 to the northeast corner thereof; thence westerly along the north line of said Section 34 and also the north line of Sections 33, 32 and 31 to the northwest corner of said Section 31, said point being also the southeast corner of Section 25, Township 27 North, Range 23 East, W.M.; thence northerly along the east line of said Section 25 to the northeast corner thereof; thence westerly along the north line of said Section 25 and also the north line of Section 26, Township 27 North, Range 23 East, W.M. to the northwest corner of said Section 26; thence southerly along the west line of said Section 26 and also the west line of Section 35, Township 27 North, Range 23 East, W.M., and also the west line of Sections 2 and 11, Township 26 North, Range 23 East, W.M. to the southwest corner of said Section 11, said point being also the northeast corner of Section 15, Township 26 North, Range 23 East, W.M.; thence westerly along the north line of said Section 15 and also the north line of Sections 16, 17 and 18, Township 26 North, Range 23 East, W.M, and also the north line of Section 13 and 14, Township 26 North, Range 22 East, W.M. to the northwest corner of said Section 14; thence southerly along the west line of said Section 14 to the southwest corner thereof, said point being also the northeast corner of Section 22, Township 26 North, Range 22 East, W.M.; thence westerly along the north line of said Section 22 and also the north line of Sections 21, 20, and 19 to the northwest corner of said Section 19; thence southerly along the west line of said Section 19 and also the west line of Section 30, Township 26 North, Range 22 East, W.M. to the southwest corner of said Section 30, said point being also the northeast corner of Section 36, Township 26 North, Range 21 East, W.M.; thence westerly along the north line of said Section 36 to the northwest corner thereof; thence southerly along the west line of said Section 36 to the southwest corner thereof, said point being also the northeast corner of Section 2, Township 25 North, Range 21 East, W.M.; thence westerly along the north line of said Section 2 to the northwest corner thereof; thence southerly along the west line of said Section 2 and also the west line of Sections 11, 14, 23, 26 and 35, Township 25 North, Range 21 East, W.M. to the southwest corner thereof, said point being also on the Sixth Standard Parallel; thence westerly along said Sixth Standard Parallel to the northwest corner of Section 3, Township 24 North, Range 21 East, W.M.; thence southerly along the west line of said Section 3 to the southwest corner thereof, said point being also the northeast corner of Section 9, Township 24 North, Range 21 East, W.M.; thence westerly along the north line of said Section 9 to the northwest corner thereof; thence southerly along the west line of said Section 9 and also the west line of Section 16, Township 24 North, Range 21 East, W.M. to the southwest corner of said Section 16; thence easterly along the south line of said Section 16 and also the south line of Sections 15 and 14 to the southeast corner of said Section 14, said point being also the northwest corner of Section 24, Township 24 North, Range 21 East, W.M.; thence southerly along the west line of said Section 24 to the southwest corner thereof; thence easterly along the south line of said Section 24 and also the south line of Section 19, Township 24 North, Range 22 East, W.M. to the southeast corner of said Section 19, said point being also the northwest corner of Section 29, Township 24 North, Range 22 East, W.M.; thence southerly along the west line of said Section 29 to the southwest corner thereof; thence easterly along the south line of said Section 29 to the southeast corner thereof, said point being also the northwest corner of Section 33, Township 24 North, Range 22 East, W.M.; thence southerly along the west line of said Section 33 and also the west line of Sections 4, 9, 16, 21, 28 and 33, Township 23 North, Range 22 East, W.M. to the southwest corner of said Section 33, said point being also the northeast corner of Section 5, Township 22 North, Range 22 East, W.M.; thence westerly along the north line of said Section 5 and also the north line of Section 6, Township 22 North, Range 22 East, W.M., and also the north line of Sections 1 and 2, Township 22 North, Range 21 East, W.M. to the northwest corner of said Section 2; thence southerly along the west line of said Section 2 and also the west line of Section 11, Township 22 North, Range 21 East, W.M. to an intersection with the centerline of Grant Road; thence westerly along the centerline of

said Grant Road to the west line of Section 9, Township 22 North, Range 21 East, W.M.; thence northerly along the west line of said Section 9 to the centerline of 10<sup>th</sup>. St. NE.; thence westerly along the centerline of said 10<sup>th</sup>. St. NE. to the centerline of N. Nile Avenue; thence southerly along the centerline of said N. Nile Avenue to an intersection with an easterly extension of the northerly right of way of Grant Road; thence westerly along said northerly right of way of said Grant Road, as said line would continue through points of intersecting street right of way lines, westerly to an intersection with the easterly right of way of N. Kentucky Avenue; thence northerly along said east right of way of N. Kentucky Avenue, as said line would continue through points of intersecting street right of way lines, to an easterly extension of the centerline of 3<sup>rd</sup>. St. NE.; thence westerly along the centerline of said 3<sup>rd</sup>. St. NE. and it's easterly extension to the centerline of Eastmont Avenue; thence northerly along the centerline of said Eastmont Avenue to an intersection with a northeasterly extension of the centerline of 2<sup>nd</sup>. St. NE.; thence southwesterly along the centerline of said 2<sup>nd</sup>. St. NE. and it's northeasterly extension to the centerline of N. Colorado Avenue; thence northwesterly along the centerline of said N. Colorado Avenue to the centerline of 5<sup>th</sup>. St. NE.; thence southwesterly along the centerline of said 5<sup>th</sup>. St. NE. to the centerline of N. Baker Avenue; thence northwesterly along the centerline of said N. Baker Avenue to the centerline of 9<sup>th</sup>. St. NE.; thence southwesterly along the centerline of said 9<sup>th</sup>. St. NE. and it's southwesterly extension to the TRUE POINT OF BEGINNING.



COMMISSIONER DISTRICT 3

December 13, 2021

Commencing at the intersection of a westerly extension of the east-west center-section line of Section 25, Township 24 North, Range 20 East, W.M. and the Boundary of Douglas County, being also the main channel of the Columbia River, said point being the TRUE POINT OF BEGINNING FOR THIS DESCRIPTION; thence northerly, easterly and southerly along said Boundary of Douglas County and said main channel of the Columbia River to an intersection with the Seventh Standard Parallel at an easterly extension of the south line of Section 36, Township 29 North, Range 30 East, W.M.; thence westerly continuing along said Boundary of Douglas County on said Seventh Standard Parallel to the northeast corner of Section 1, Township 28 North, Range 29 East, W.M.; thence southerly continuing along said Boundary of Douglas County on the east line of said Section 1 to the southeast corner thereof; thence continuing along said Boundary of Douglas County on the south line of said Section 1 to the southwest corner thereof, said point being also the northeast corner of Section 11, Township 28 North, Range 29 East, W.M.; thence southerly continuing along said Boundary of Douglas County on the east line of said Section 11 and also the east line of Section 14, Township 28 North, Range 29 East, W.M. to the southeast corner of said Section 14; thence westerly continuing along said Boundary of Douglas County on the south line of said Section 14 to the southwest corner thereof, said point being also the northeast corner of Section 22, Township 28 North, Range 29 East, W.M.; thence southerly continuing along said Boundary of Douglas County on the east line of said Section 22 to the southeast corner thereof; thence westerly continuing along said Boundary of Douglas County on the south line of said Section 22 and also the south line of Section 21, Township 28 North, Range 29 East, W.M. to the southwest corner of said Section 21, said point being also the northeast corner of Section 29, Township 28 North, Range 29 East, W.M.; thence southerly continuing along said Boundary of Douglas County on the east line of said Section 29 to the southeast corner thereof; thence westerly continuing along said Boundary of Douglas County on the south line of said Section 29 to the southwest corner thereof, said point being also the northeast corner of Section 31, Township 28 North, Range 29 East, W.M.; thence southerly continuing along said Boundary of Douglas County on the east line of said Section 31, and also the east line of Sections 6, 7, 18, 19 and 30, Township 27 North, Range 29 East, W.M. to the southeast corner of said Section 30; thence westerly continuing along said Boundary of Douglas County on the south line of said Section 30 to the southwest corner thereof, said point being also the northeast corner of Section 36, Township 27 North, Range 28 East, W.M.; thence southerly continuing along said Boundary of Douglas County on the east line of said Section 36 and also the east line of Section 1, Township 26 North, Range 28 East, W.M. to the southeast corner of said Section 1; thence westerly continuing along said Boundary of Douglas County on the south line of said Section 1 to the southwest corner thereof, said point being also the northeast corner of Section 11, Township 26 North, Range 28 East, W.M.; thence southerly continuing along said Boundary of Douglas County on the east line of said Section 11 and also the east line of Section 14, Township 26 North, Range 28 East, W.M. to the southeast corner of said Section 14; thence westerly continuing along said Boundary of Douglas County on the south line of said Section 14 to the southwest corner thereof, said point being also the northeast corner of Section 22, Township 26 North, Range 28 East, W.M.; thence southerly continuing along said Boundary of Douglas County on the east line of said Section 22 to the southeast corner thereof; thence westerly continuing along said Boundary of Douglas County on the south line of said Section 22 to the southwest corner thereof, said point being also the northeast corner of Section 28, Township 26 North, Range 28 East, W.M.; thence southerly





continuing along said Boundary of Douglas County on the east line of said Section 28 and also the east line of Section 33, Township 26 North, Range 28 East, W.M. and also the east line of Sections 4 and 9, Township 25 North, Range 28 East, W.M. to the southeast corner of said Section 9; thence westerly continuing along said Boundary of Douglas County on the south line of said Section 9 to the southwest corner thereof, said point being also the northeast corner of Section 17, Township 25 North, Range 28 East, W.M.; thence southerly continuing along said Boundary of Douglas County on the east line of said Section 17 and also the east line of Sections 20 and 29, Township 25 North, Range 28 East, W.M. to the southeast corner of said Section 29; thence westerly continuing along said Boundary of Douglas County on the south line of said Section 29 to the southwest corner thereof, said point being also the northeast corner of Section 31, Township 25 North, Range 28 East, W.M.; thence southerly continuing along said Boundary of Douglas County on the east line of said Section 31 to the centerline of US-2; thence westerly leaving said Boundary of Douglas County along the centerline of said US-2 to an intersection with the west line of Section 6, Township 24 North, Range 26 East, W.M.; thence northerly along the west line of said Section 6 to the northwest corner thereof, said point being also on the Sixth Standard Parallel; thence westerly along said Sixth Standard Parallel to the southeast corner of Section 36, Township 25 North, Range 25 East, W.M.; thence northerly leaving said Sixth Standard Parallel along the east line of said Section 36 and also the east line of Section 25, Township 25 North, Range 25 East, W.M. to the northeast corner of said Section 25; thence westerly along the north line of said Section 25 and also the north line of Section 26, Township 25 North, Range 25 East, W.M. to the northwest corner thereof, said point being also the southeast corner of Section 22, Township 25 North, Range 25 East, W.M.; thence northerly along the east line of said Section 22 to the northeast corner thereof, said point being also the southwest corner of Section 14, Township 25 North, Range 25 East, W.M.; thence easterly along the south line of said Section 14 to the southeast corner thereof; thence northerly along the east line of said Section 14 and also the east line of Sections 11 and 2, Township 25 North, Range 25 East, W.M. and also the east line of Section 35, Township 26 North, Range 25 East, W.M. to the northeast corner of said Section 35; thence westerly along the north line of said Section 35 and also the north line of Sections 34 and 33, Township 26 North, Range 25 East, W.M. to the northwest corner of said Section 33, said point being also the southeast corner of Section 29, Township 26 North, Range 25 East, W.M.; thence northerly along the east line of said Section 29 and also the east line of Sections 20 and 17, Township 26 North, Range 25 East, W.M. to the northeast corner of said Section 17; thence westerly along the north line of said Section 17 and also Section 18, Township 26 North, Range 25 East, W.M. to the northwest corner of said Section 18, said point being also the southeast corner of Section 12, Township 26 North, Range 24 East, W.M.; thence northerly along the east line of said Section 12 and also the east line of Section 1, Township 26 North, Range 24 East, W.M. to the northeast corner of said Section 1; thence westerly along the north line of said Section 1 and also the north line of Section 2, Township 26 North, Range 24 East, W.M. to the northwest corner of said Section 2, said point being also the southeast corner of Section 34, Township 27 North, Range 24 East, W.M.; thence northerly along the east line of said Section 34 to the northeast corner thereof; thence westerly along the north line of said Section 34 and also the north line of Sections 33, 32 and 31 to the northwest corner of said Section 31, said point being also the southeast corner of Section 25, Township 27 North, Range 23 East, W.M.; thence northerly along the east line of said Section 25 to the northeast corner thereof; thence westerly along the north line of said Section 25 and also the north line of Section 26, Township 27 North, Range 23 East, W.M. to the northwest corner of said Section 26; thence southerly along the west line of said Section 26 and also the west line of Section 35, Township 27 North, Range 23 East, W.M., and also the west line of Sections 2 and 11, Township 26 North, Range 23 East, W.M. to the southwest corner of said Section 11, said point being also the northeast corner of Section 15, Township 26 North, Range 23 East, W.M.; thence westerly along the north line of said Section 15 and also the north line of Sections 16, 17 and 18, Township 26 North, Range 23 East, W.M., and also the north line of Sections 13 and 14, Township 26 North, Range 22 East, W.M. to the

northwest corner of said Section 14; thence southerly along the west line of said Section 14 to the southwest corner thereof, said point being also the northeast corner of Section 22, Township 26 North, Range 22 East, W.M.; thence westerly along the north line of said Section 22 and also the north line of Sections 21, 20, and 19 to the northwest corner of said Section 19; thence southerly along the west line of said Section 19 and also the west line of Section 30, Township 26 North, Range 22 East, W.M. to the southwest corner of said Section 30, said point being also the northeast corner of Section 36, Township 26 North, Range 21 East, W.M.; thence westerly along the north line of said Section 36 to the northwest corner thereof; thence southerly along the west line of said Section 36 to the southwest corner thereof, said point being also the northeast corner of Section 2, Township 25 North, Range 21 East, W.M.; thence westerly along the north line of said Section 2 to the northwest corner thereof; thence southerly along the west line of said Section 2 and also the west line of Sections 11, 14, 23, 26 and 35, Township 25 North, Range 21 East, W.M. to the Sixth Standard Parallel; thence westerly along said Sixth Standard Parallel to the northwest corner of Section 3, Township 24 North, Range 21 East, W.M.; thence southerly along the west line of said Section 3 to the southwest corner thereof, said point being also the northeast corner of Section 9, Township 24 North, Range 21 East, W.M.; thence westerly along the north line of said Section 9 to the northwest corner thereof; thence southerly along the west line of said Section 9 and also the west line of Section 16, Township 24 North, Range 21 East, W.M. to the southwest corner of said Section 16; thence easterly along the south line of said Section 16 and also the south line of Sections 15 and 14 to the southeast corner of said Section 14, said point being also the northwest corner of Section 24, Township 24 North, Range 21 East, W.M.; thence southerly along the west line of said Section 24 to the southwest corner thereof; thence easterly along the south line of said Section 24 and also the south line of Section 19, Township 24 North, Range 22 East, W.M. to the southeast corner of said Section 19, said point being also the northwest corner of Section 29, Township 24 North, Range 22 East, W.M.; thence southerly along the west line of said Section 29 to the southwest corner thereof; thence easterly along the south line of said Section 29 to the southeast corner thereof, said point being also the northwest corner of Section 33, Township 24 North, Range 22 East, W.M.; thence southerly along the west line of said Section 33 and also the west line of Sections 4, 9, 16, 21, 28 and 33, Township 23 North, Range 22 East, W.M. to the southwest corner of said Section 33, said point being also the northeast corner of Section 5, Township 22 North, Range 22 East, W.M.; thence westerly along the north line of said Section 5 and also the north line of Section 6, Township 22 North, Range 22 East, W.M., and also the north line of Sections 1 and 2, Township 22 North, Range 21 East, W.M. to the northwest corner of said Section 2; thence southerly along the west line of said Section 2 and also the west line of Section 11, Township 22 North, Range 21 East, W.M. to an intersection with the centerline of Grant Road; thence westerly along the centerline of said Grant Road to the west line of Section 9, Township 22 North, Range 21 East, W.M.; thence northerly along the west line of said Section 9 to the centerline of 10<sup>th</sup>. St. NE.; thence westerly along the centerline of said 10<sup>th</sup>. St. NE. to the centerline of N. Nile Avenue; thence southerly along the centerline of said N. Nile Avenue to an intersection with the northerly right of way of Grant Road extended easterly; thence westerly along said northerly right of way of Grant Road and it's easterly and westerly extensions, as said line would continue through points of intersecting street right of way lines, to an intersection with the southerly extension of the east right of way of N. Kentucky Avenue; thence northerly along said east right of way of N. Kentucky Avenue, as said line would continue through points of intersecting street right of way lines, to an intersection with the east line of Section 12, Township 22 North, Range 20 East, W.M.; thence northerly along said east line of Section 12 to the northeast corner thereof; thence westerly along the north line of said Section 12 to an intersection with the north right of way of 10<sup>th</sup>. St. NE.; thence westerly along the north right of way of said 10<sup>th</sup>. St. NE. to the east right of way of N. Jackson Avenue; thence northerly along the east right of way of said N. Jackson Avenue to an intersection with a line that is at an angle of 90° easterly of the north-south center-section line of Section 1, Township 22 North, Range 20 East, W.M., and 1004.4 feet north of the south quarter corner of said Section 1; thence

westerly along said line to the north-south center-section line of said Section 1; thence northerly along said north-south center-section line to the center of said Section 1; thence westerly along the east-west center-section line of said Section 1 to the west quarter corner of said Section 1 and the centerline of Eastmont Avenue; thence northerly along the centerline of said Eastmont Avenue to a intersection between the centerline of said Eastmont Avenue and a line between the southeast corner of Lot 32, Earhart Heights Subdivision and the southwest corner of Parcel 3, Floyd Crane Short Plat; thence northwesterly along said line to the southeast corner of said Lot 32; thence westerly along the south line of said Lot 32 to the southwest corner thereof; thence northerly along said west line to the southeast corner of Lot 1, Orchards Short Subdivision; thence westerly along the south line of said Lot 1 and also the south line of Lots 2 and 3 of said Orchards Short Subdivision to the southwest corner of said Lot 3; thence northerly along the west line of said Lot 3 to the northwest corner thereof, said point being also on the north line of Lot 4, Block 3, East Wenatchee Fruit Farms; thence westerly along said north line of Lot 4, Block 3 to the northwest corner thereof; thence southerly along the west line of said Lot 4, Block 3 to the north line of the Plat of Tanglewood Townhomes; thence northwesterly along said north line of the Plat of Tanglewood Townhomes to the northeast corner of The Legends Condominiums; thence northwesterly along the north line of said The Legends Condominiums to the east line of the Country Club Crescent Condominiums; thence northerly and northwesterly along the north line of said Country Club Crescent Condominiums to the northwest corner thereof, said point being also on the easterly right of way of the Greater Wenatchee Irrigation District Canal; thence southwesterly crossing said Greater Wenatchee Irrigation District Canal to the northeast corner of Canyon Creek Condominiums; thence southwesterly along the north line of said Canyon Creek Condominiums to the northwest corner thereof; thence westerly to the west right of way of N. Baker Avenue; thence southerly along the west right of way of said N. Baker Avenue to the north right of way of 19<sup>th</sup>. St. NE.; thence westerly along said north right of way of 10<sup>th</sup>. St. NE. and it's westerly extension to the centerline of SR-28; thence northerly along the centerline of said SR-28 to the centerline of 23<sup>rd</sup>. St. NE.; thence easterly along the centerline of said 23<sup>rd</sup>. St. NE. to the centerline of Eastmont Avenue; thence northerly along the centerline of said Eastmont Avenue to the center of Canyon B; thence southwesterly along the said center of Canyon B to the north-south center-section line of Section 26, Township 23 North, Range 20 East, W.M.; thence northerly along said north-south center-section line of said Section 26 to the center of said Section 26; thence westerly along the east-west center-section line of said Section 26 to the east right of way of SR-28; thence northerly along the said east right of way of SR-28, as said line would continue through points of intersecting street right of way lines, to the north line of Section 26, Township 23 North, Range 20 East, W.M.; thence easterly along said north line of Section 26 to the northeast corner thereof; thence southerly along the east line of said Section 26 and also the west line of Sections 24 and 25, Township 23 North, Range 20 East, W.M. to the west quarter corner of said Section 25; thence easterly along the east-west center-section line of said Section 25 and also the east-west center-section line of Sections 30 and 29, Township 23 North, Range 21 East, W.M. to the east quarter corner of said Section 29; thence northerly along the east line of said Section 29 and also the west line of Sections 28, 21, 16, 9 and 4, Township 23 North, Range 21 East, W.M. to the northwest corner of said Section 4, said point being also the southeast corner of Section 32, Township 24 North, Range 21 East, W.M.; thence westerly along the south line of said Section 32 to the southwest corner thereof; thence northerly along the west line of said Section 32 and also the west line of Section 29, Township 24 North, Range 21 East, W.M. to the northwest corner of said Section 29, said point being also the northeast corner of Section 30, Township 24 North, Range 21 East, W.M.; thence westerly along the north line of said Section 30 to the northwest corner thereof, said point being also the east quarter corner of Section 25, Township 24 North, Range 20 East, W.M.; thence westerly along the east-west center-section line of said Section 25 and it's westerly extension to the TRUE POINT OF BEGINNING.



# Current Commissioner District Boundaries

### Legend

**Current Commissioner Districts**

- Commissioner District #1
- Commissioner District #2
- Commissioner District #3
- City Limits

**Roads**

- Major Public Road
- Minor Public Road
- Private Road
- Section

**Current Total Population:**

- Douglas County Commissioner District #1: 14,323
- Douglas County Commissioner District #2: 14,641
- Douglas County Commissioner District #3: 13,974

**Current Hispanic / Latinx Population:**

- Douglas County Commissioner District #1: 4,274
- Douglas County Commissioner District #2: 4,894
- Douglas County Commissioner District #3: 5,466

Douglas County  
 Transportation & Land Services  
 Public Services Building  
 140 - 19TH ST NW, Suite A  
 East Wenatchee, WA 98802  
 (509) 884-7173



Date: 12/2/2021

Note: This map is intended for general information purposes only. Douglas County makes no claim as to the accuracy or current condition of the data shown on this map.

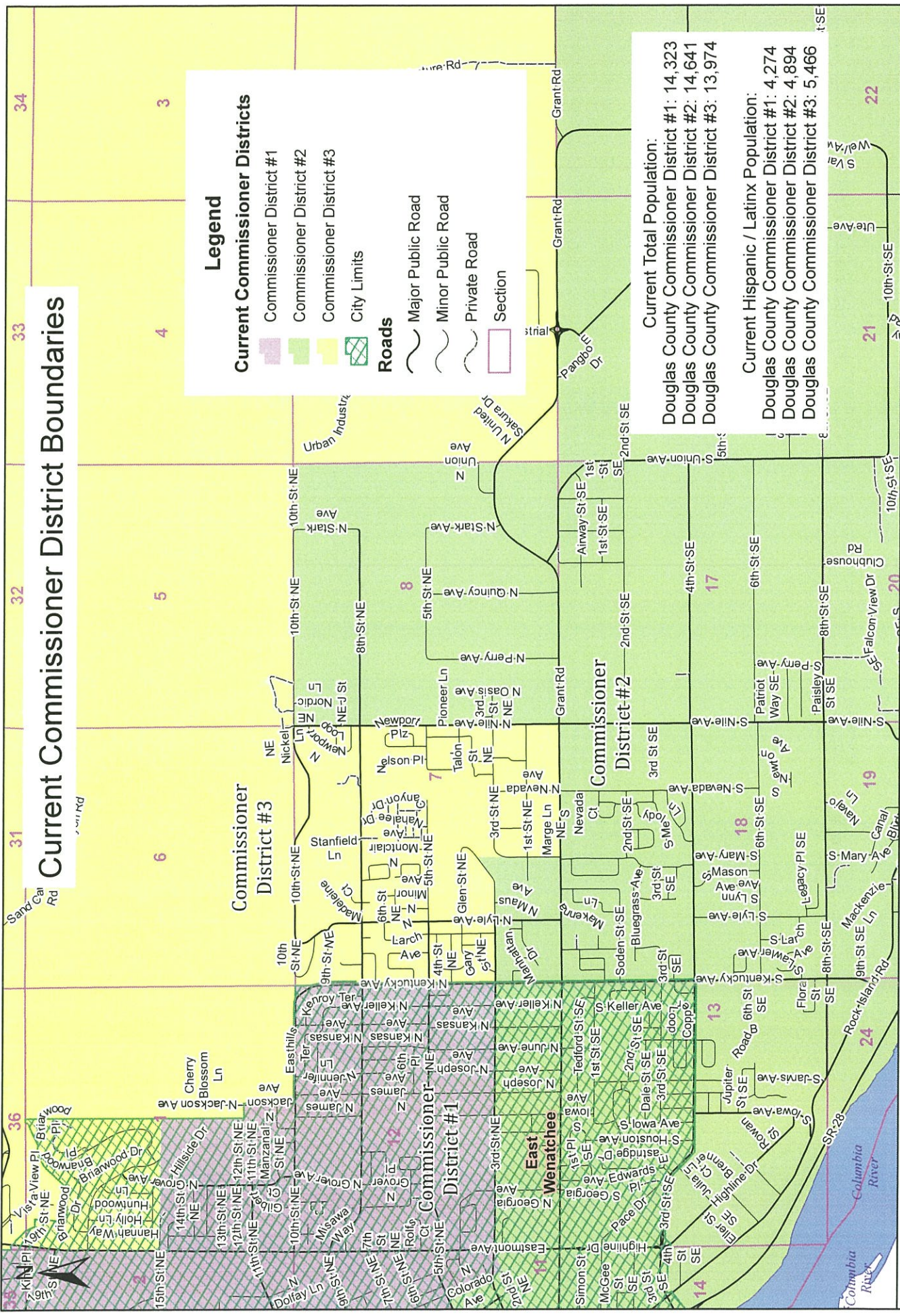



# New Commissioner District Boundaries

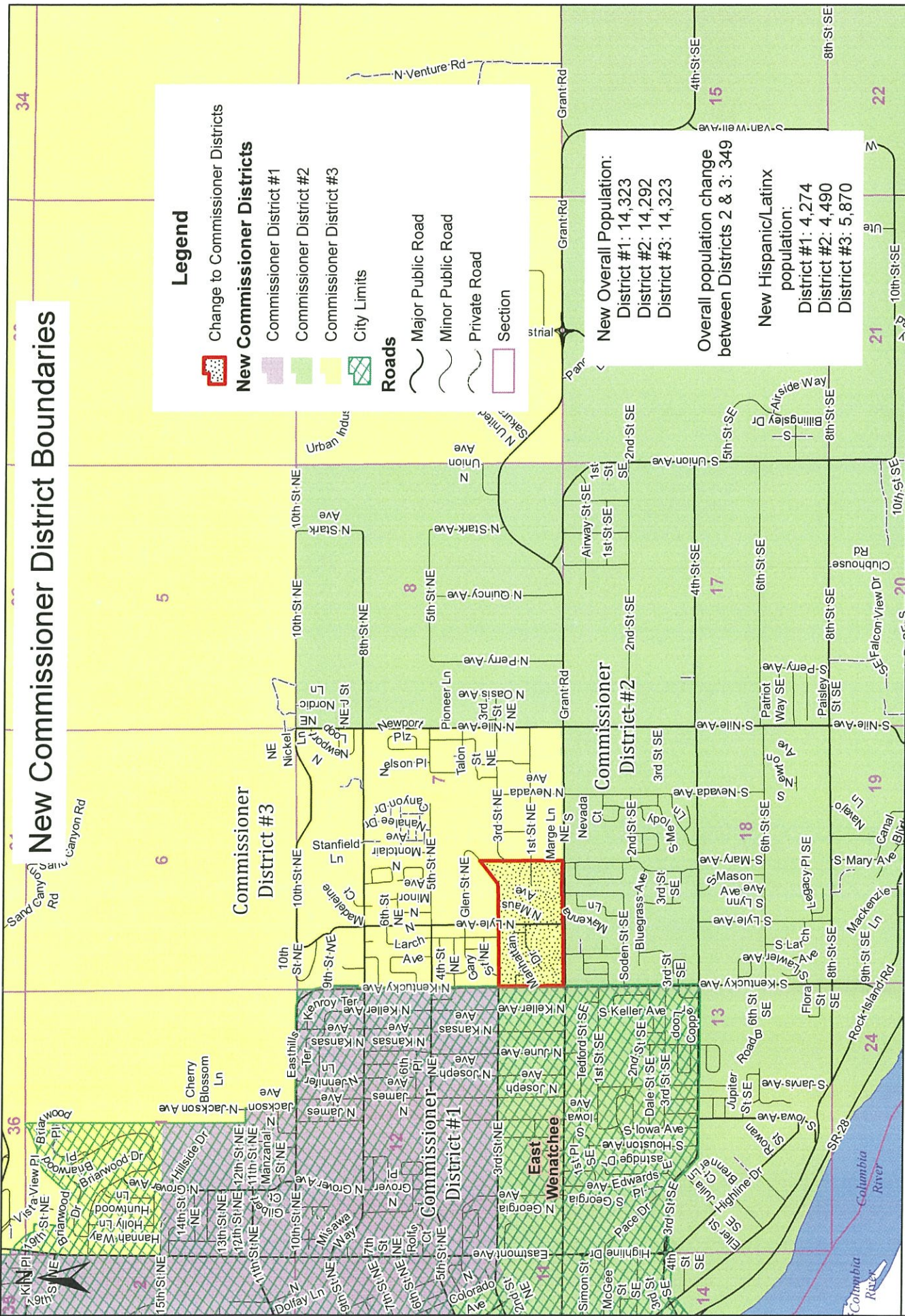

**Legend**

- Change to Commissioner Districts
- New Commissioner Districts**
- Commissioner District #1
- Commissioner District #2
- Commissioner District #3
- City Limits

**Roads**

- Major Public Road
- Minor Public Road
- Private Road
- Section

**New Overall Population:**

- District #1: 14,323
- District #2: 14,292
- District #3: 14,323

**Overall population change between Districts 2 & 3: 349**

**New Hispanic/Latinx population:**

- District #1: 4,274
- District #2: 4,490
- District #3: 5,870

Douglas County  
 Transportation & Land Services  
 Public Services Building  
 140 - 19TH ST NW, Suite A  
 East Wenatchee, WA 98802  
 (509) 884-7173



Date: 12/2/2021

Note: This map is intended for general information purposes only. Douglas County makes no claim as to the accuracy or current condition of the data shown on this map.